

# Moorings 48.4

## Specifications and Equipment List - Moorings Upgrades In Bold

### DECK & HULL

---

- Design in accordance with European Directive requirements and according to EC certification
- Monolithic hull in polyester
- Monolithic structural hull liner bonded to the hull
- Injection molded deck in glass fiber/balsa sandwich, covered with diamond-point non-slip coating
- **White hull with Moorings graphics**
- Deck hull joint screwed, bonded and banded with 1 solid wood bulwark
- Cast iron keel fixed with bolts and stainless steel backing plates
- **Shoal keel**
- Rudder hung with glass compound stock
- Self-bailing chain locker - Clench bolt - Hatch cover
- Stainless steel bow fitting 2 rollers
- Sail locker forward: Access via lockable deck hatch and (stainless steel) ladder
- 6 Aluminum mooring cleats - Stainless steel deck line protection
- 1 Open stainless steel forward pulpit
- 2 Stainless steel aft pushpits
- **Double stainless steel lifelines uncoated and stainless steel stanchions - Access to port and starboard in lifelines**
- 1 x Flag pole holder (stainless steel)
- Horseshoe buoy with holder
- **Electronically controlled, fully opening transom, convertible into swim platform with natural solid wood decking (2,85 m x 0,77 m / 9ft 4in x 2ft 6in)**
- **1 Stainless steel folding swim ladder - Solid wood steps, backing plate & additional stainless steel protection**
- **Outboard engine bracket**
- **12v - 1500w Electric windlass with 12mm gypsy, hand control wired direct and cockpit chain counter**
- **Double stemhead anchor roller**
- **Transom protection**
- **Bow thruster**

### COCKPIT & COMPANIONWAY

---

- Self-bailing cockpit
- 2 Cockpit lockers
- 2 Lockers in cockpit floor under helm's feet
- 1 Liferaft locker under helm seat (0,80 m x 0,40 m x 0,58 m / 2ft 7in x 1ft 4in x 1ft 11in)
- **2 Gas lockers for 10lb propane bottles**
- 2 Steering wheel consoles: Stainless steel steering wheels - 900 mm diameter - Steering gear at the helm station - Metal cable transmission system - Stainless steel handrail - Fixed navigation instrument pod - Glass holder
- 1 Deck filler for access to tiller system
- 1 Emergency tiller
- 2 Steering compasses on consoles
- Portside engine control and control panel
- Polyester cockpit table - 2 leaves - Glove boxes - 2 Large storage space - Stainless steel handrail - 12v Power outlet
- 1 Fixed composite arch - Built-in lighting
- 2 Hinged PMMA companionway doors - Sliding hatch made of PMMA
- **Wooden salon companionway with molded wood hanging steps with molded non-slip surface**
- **Natural solid wood slatted cockpit benches**
- **Hanging light in cockpit**
- **Hasp on companionway hatch**
- **Bimini & dodger**

### MAST, RIGGING & SAILS

---

- **Custom heavy duty battened charter mainsail**
- **Custom heavy duty charter furling genoa with Moorings blue UV protection strips**
- **Stackpack lazy bag with Moorings logo**
- Mast 9/10 anodized aluminum installed on the deck, 2 sets of spreaders
- Anodised aluminium boom
- Discontinuous (stainless steel) standing rigging
- 2 Backstay: Bridle
- Rigid boom vang
- **Genoa Profurl furling system with drum on the deck**

- 2 Stand Up blocks on mainsheet arch
- 2 Genoa tracks with piston adjusted traveller cars
- 2 Genoa sheet return blocks
- Rigging run back to cockpit (except boom topping lift)
- Complete running rigging: Main halyard, Genoa halyard with clutch on mast and cleat, Boom topping lift with cleat on mast, Mainsheet, 2 Genoa sheets 2 Reefing lines
- 2 Self-tailing genoa sheet winches (H60.2 STC)
- **2 Self-tailing halyard winches (1 electric) -- (H46.2 STC)**
- 2 Aluminum winch handles
- 2 Winch handle holders
- 8 Line stoppers
- **Alloy sheaves & gooseneck bushing**
- **Protection guard on steaming light**
- **Windex wind vane**

## SALOON/INTERIOR

---

- **Light satin oak interior**
- Parquet type laminated floors
- Salon Headroom: 1,98 m / 6ft 6in
- U-shaped salon seating and additional bench with backrest - in double density foam
- Salon table in 1 piece - Varnished wood top with inlay - Aluminum legs
- Mirror on bulkhead
- Cupboard units - Cubby hole lockers and storage along the hull - Storage under bench seats
- 2 Panoramic deck house windows with concertina blinds
- 2 Hull portholes
- 2 Opening portholes on coaming in side windows
- Shelves with stainless steel fiddles
- 3 flush deck hatches
- **Taupe interior padding**
- **Faux leather saloon cushions**
- **Saloon table converts to a double berth**
- **Wine bottle holder below floor**
- **Mosquito screens for portlights**

## GALLEY

---

- Galley Headroom: 1.98 m / 6ft 6in
- U-shaped galley
- Compact grey laminated worktop
- 1 Stainless steel sink 2 rectangular basins - 1 Mixer tap cold water / hot water, under pressure
- 1 x 12v 130 L refrigerator / 34 US Gal, front opening
- **1 x 12v 100 L ice box / 26 US Gal, with freezer section, top opening**
- Fitted cupboards and closed cubbyholes (Shelving, Garbage bin)
- 1 Base cabinet: 1 Drawer - 2 shelves
- Storage space along the hull
- 2 Opening ports on coaming on side windows
- **1 Gas stove 3 burners - Stainless steel oven on gimbal mountings - Stainless steel protection handrail**
- **Propane solenoid valve**

## ENGINE & CONTROLS

---

- **Yanmar 4JH80 -- 80 hp common rail diesel engine with sail drive**
- 1 Rotomoulded diesel tank 200 L / 53 US Gal (under port aft berth) - Electronic gauge - Low level alarm - 1 Deck filler
- Engine control - Control panel in cockpit
- Engine compartment: Soundproofing foam - Ventilation: 1 air intake and 1 air outlet
- 1 Alternator 12v / 125 Amp
- Filters: Sea water - Diesel - Water separator
- Fixed three blade propeller
- 1 Engine access through companionway (opening with 2 gas pistons) - 2 Engine access through aft cabins
- **6kw Onan generator with seawater diesel and racor filter**

## PLUMBING INSTALLATION

---

- 1 Rotomolded freshwater tank (370L / 98 USgal forward cabin) - 1 deck filler
- **Additional 330L / 87USgal water tank**
- Waterpressure system - Expansion tank - Inline filter
- **Quick 40 L / 11 Gal Water Heater**
- Automated shower drains
- 1 Electric bilge pump - 1 Manual bilge pump

- 1 Electric ice box drain pump
- **Hot & cold water shower in cockpit**

## ELECTRICAL INSTALLATION

---

- 12v circuit for house and engine systems, 12v plugs at nav station, 110/220v plugs in each cabin, saloon, chart table and galley
- 12v Electrical panel (Fuses - Voltmeter - Water gauge - Fuel gauge - Battery warning - Fuel warning - Water warning)
- 1 x 12v Power outlet
- 2 Fixed shore power cables
- **LED navigation and anchoring lights**
- Wire runs for optional cables
- 1 x 110ah Lead acid engine battery
- **House battery bank -- 4 Dryfit gel batteries**
- 110v or 220v circuit shore-power outlets distributor
- **LED lights throughout**
- **Fans in saloon and all cabins**
- **2 x USB ports in each cabin**
- **Fusion 700i Radio / Mp3 player + 2 interior speakers + 2 cockpit speakers**
- **Battery charger 60amp**
- **12" Multifunction touchscreen display in cockpit with fixed pod (WIFI enabled)**
- **1 x Tridata**
- **1 x Autopilot control head**
- **Hydraulic linear drive autopilot**
- **Depth sounder & anemometer windvane**
- **VHF with AIS (receiving only)**
- **Air conditioning**
- **TV/DVD and bracket in the saloon**
- **Moorings marine smarhub (wifi via cellular network and stored local content)**

## NAVIGATION CONSOLE

---

- Chart table storage beneath hinged top - Molded wood beading
- Switch panel on bulkhead for access to electrical functions
- 1 Reading light

## FORWARD CABINS

---

- Forward Cabin Headroom: 6ft 4in / 1.92
- Central double bed (1.38m x 0.75m x 2.10m / 4ft 6in x 2ft 6in x 6ft 11in)
- **Grey covered foam mattresses**
- Hanger closets - Cubby hole locker - Base cabinet
- Access door for the head
- 1 Hull porthole
- 1 Flush deck hatch

## FORWARD HEADS

---

- Forward Head Headroom: 6ft 4in / 1.92m
- Access through forward cabin
- Moulded basin - mixing tap hot/cold water; retractable for shower use
- 1 Mirror
- Toilet accessories
- 1 Opening deck hatch
- **PMMA shower screen**
- **Large bowl Quiet Flush electric marine toilet with individual holding tank**

## AFT CABINS

---

- Aft Cabin headroom: 6ft 1in / 1.86m
- Double bed (1.55m x 1.35m x 2.05m / 5ft 1in x 4ft 5in x 6ft 9in)
- **Grey covered foam mattresses**
- Cupboard - Hanging locker - Stowage
- Storage space along the full length of the bed
- Access door for the head
- 1 Large size hull port with curtain
- 1 Flush deck hatch
- 1 Cockpit window
- **Grey covered foam mattresses**
- 1 Porthole opening onto cockpit

## STARBOARD AFT HEAD

---

- Starboard Aft Head headroom: 1.92m / 6ft 4in
- Separate shower - 1 Mixing tap hot water / Cold water
- Moulded basin - mixing tap hot/cold water
- 2 Mirrors
- Toilet accessories
- **PMMA shower screen**
- **Large bowl Quiet Flush electric marine toilet with individual holding tank**

## PORT AFT HEAD

---

- Port Aft Head headroom: 1.92m / 6ft 4in
- Access via the cabin and salon
- Rigid holding tank: 64L / 17 USgal
- Moulded basin - mixing tap hot/cold water
- Shower hose
- 1 Mirror
- Toilet accessories
- 1 Opening deck hatch
- **PMMA shower screen**
- **Large bowl Quiet Flush electric marine toilet with individual holding tank**

## SAFETY GEAR

---

- **Primary (stainless steel) and secondary (galvanized) anchors**
- **6 x Fenders**
- **6 x Mooring / dock lines**
- **Lifejackets and safety harnesses per max pax**
- **Bell**
- **Flare kit**
- **Binoculars**
- **Navigation tools: Parallel rule, compass, dividers**

## CRUISING GEAR

---

- **Bed linens per max pax**
- **Plates, cups, saucers, glasses per max pax**
- **Flatware per max pax**
- **Pots, pans, miscellaneous food prep**
- **Cooking utensils**
- **Coffee pot, tea, kettle, toaster**
- **Snorkeling gear per max pax**
- **Towels and washcloths per max pax**
- **Cockpit cushions per max pax**

## GENERAL SPECIFICATIONS

Length Overall:	14.60m/47ft 11in
Waterline Length:	13.86m/45ft 6in
Beam:	4.74m/15ft 7in
Draft:	1.83m/6ft 0in
Displacement:	12594kg/27765lb
Fuel Capacity:	200L/52gal
Water Capacity:	700L/185gal
Engine:	Yanmar 80 hp CR Sail Drive

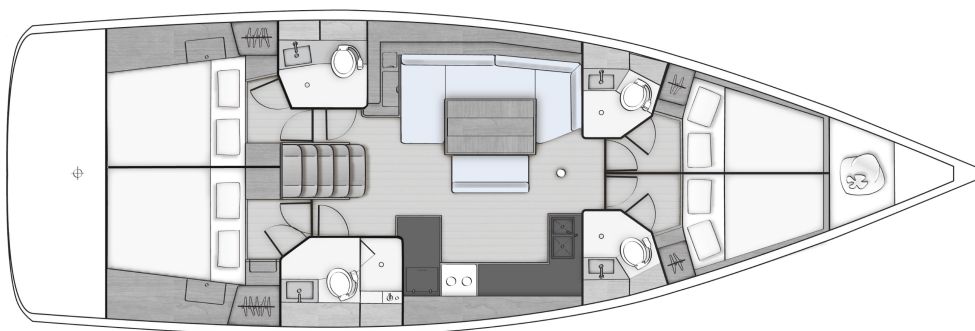

*The Builder reserves the right to change or amend the contents of this document at any time without prior notification to any third party, and no liability will be accepted for errors contained within the same.*