

The Moorings 4400

STANDARD BOAT EQUIPMENT LIST - MOORINGS UPGRADES ON FINAL PAGE*

SALOON

Laminate finishes with solid wood trims
Wear resistant simulated flooring
Saloon table and settee
Overhead LED lighting
Ample ventilation through forward facing portlights
Stowage space under settee cushions
Watertight door access to the forward cockpit

GALLEY

Corian galley worktop surfaces
Single lever mixer faucet
Double sink (stainless steel)
Dish and cutlery drying recess with drainage
Cover for drying recess
Vitrifigo 2-drawer front-opening fridge/freezer
56USgal / 212L 12v
ENO gas 3-burner stovetop & oven
Gas solenoid shut-off valve with control at
switch panel & warning light at cooker
Gas cylinder regulator in dedicated cockpit LPG locker
Separate garbage bin locker with top access
Stowage space in shelf lockers
Corian galley shelf

NAVIGATION CONSOLE

Chart surface with light
Instrument and switch panel

CABINS x 4

Laminate finishes with solid wood trims
Double berths:
- Fwd Bunks (4ft 7in x 6ft 7in) (1.40m x 2m)
- Aft Bunks (4ft 11in x 6ft 7in) (1.50m x 2m)
Double bunks convertible to 2 single bunks
in forward cabins
Hanging locker
Stowage locker with shelving
LED reading lamps
Overhead LED lighting
Overhead roller blinds for privacy
Large open shelves
Stowage space under bunk
Large stowage space in forepeak
Overhead LED lighting in forepeak
Large hull window incorporating portlight

HEAD COMPARTMENTS x 4

Washbasin with basin mixer
Vanity locker with mirror
Towel hook
Towel rails
Towel ring
Overhead shower with non-slip shower sump cover
LED overhead lighting
Overhead roller blinds for privacy
PAR Brydon large bowl manual toilet*

ENGINE & CONTROLS

Morse double lever throttle / gearshift control
Sound deadening panels in engine room
2 x Engine room ventilation fans and ducting
2 x *Yanmar* 29HP diesel engines with sail drives*
2 x Propellers - 2-blade fixed
2 x Fuel deck fillers
2 x Fuel filter / water separators
2 x Fuel tanks (aluminium). Total capacity 185USgal / 700L
2 x Exhaust skin fittings (stainless steel)
2 x Exhaust water locks
2 x Cooling water inlet strainers
2 x Exhaust cooling water temperature sensors with
audible alarms at helm

PLUMBING INSTALLATION

Hot and cold pressurized fresh water system:
2 x Water tanks. Total capacity 206USgal / 780L *
1 x *Jabsco Par Max* 3.5 GPM fresh water pressure
pump with 1L *Jabsco* accumulator tank
2 x Hot water tanks. Total capacity 12USgal / 45L
Transom shower (cold)*
4 x Shower drain pumps with filters
2 x Holding tanks. Total capacity 26USgal / 100L
4 x Electric bilge pumps with float switches and alarms
at helm and nav stations
2 x Manual bilge pumps with strum boxes
2 x High water companionway bilge float switches with
audible alarm at switch panel

RUDDER & STEERING SYSTEM

Balanced spade rudders
Rudder stock in 17-4ph (stainless steel)
JP3 Self aligning bearings
Edson chain and wire steering system with bulkhead
steering unit and brake
Destroyer-type steering wheel
Emergency tiller (stainless steel)

The Moorings 4400

STANDARD BOAT EQUIPMENT LIST

ELECTRICAL INSTALLATION

LED Courtesy lights at stairways
Bi-colour & stern navlights
Plastimo Contest 130 compass at helm position
12v DC switch panel
Overcurrent protection & earth leakage interrupter fitted to main wiring circuit
2 x Fuel tank gauges at helm position
2 x Ammeters at helm position
2 x House batteries - 180Ah deep cycle lead acid type*
2 x Engine starter batteries - 96Ah lead acid type*
1 x House battery isolator switch
2 x Engine starter battery isolator switches
2 x Alternators, standard with engines
1 x Electrical spares kit: fuses, relays, fuse holders

DECK FITTINGS

Guardwires with stanchions, bases, port & stb side gates (stainless steel)
Guardwires across bow and stern
Quick - Aleph 1000w vertical windlass 10mm chain gypsy with hand-held remote windless control
Anchor bow roller fitting
Anchor chain stopper
Liferaft locker
Sliding companionway door
Hardtop over cockpit complete with lighting
Hardtop bimini over helm
Swimming ladder with teak steps
Cockpit table
Furler jammer on deck
Bridal mainsheet system (3:1 purchase)
Trampoline
Helmseat
Lifering holder with lifering
Acrylic windows
Hatches - *Lewmar*:
4 x Size 10
4 x Size 44
1 x Size 70 (Cockpit Hatch)
2 x Size 70 (Engine room hatches)
Portlights - *Lewmar*:
4 x Size 5
10 x Size 1
Side window brows
2 x Spacious foredeck lockers
1 x Forward cockpit locker
2 x Seats and 2 x folding tables in forward cockpit

DECK FITTINGS (continued)

2 x Pulpits
2 x Pushpits
2 x Coachroof handrails (stainless steel)
2 x *Lewmar* winch handles
1 x Winch handle pocket at helm
2 x Drinking can holders
2 x *Lewmar* genoa cars
2 x *Lewmar* genoa tracks
2 x Halyard jammers at helm (Main & Spare)
1 x Halyard on mast (Genoa)
2 x Genoa jammers at helm
2 x Mainsheet jammers at helm
1 x *Lewmar* 45CEST (Stb) electric halyard / sheet winch
1 x *Lewmar* 45CST (Port) halyard / sheet winch
1 x *Lewmar* 45CST main sheet winch
4 x Padeyes to allow for spinnaker tackle
2 x Reef jammers at helm
Hardtop support (stainless steel)
Port & starboard side coachroof access steps

RUNNING RIGGING

2 x Main sheets (3:1 purchase)
2 x Genoa sheets
3 x Halyards (main, genoa & spare)
2 x Reefs lead aft
Main boom topping lift

MAST, RIGGING & SAILS

Z-SPAR natural anodized mast
Z-SPAR natural anodized crossbeam
Windex wind indicator
Profurl genoa furler
Ullman mainsail full battened with 2 rows reef points
Ullman 120% furling genoa
2 x Additional spare 12v wires in mast
Additional spare conduit with messenger in mast
Winch handle pocket

GENERAL EQUIPMENT

4 x Fire extinguishers
Owner's Operating Manual
CE Certification
NMMA Certification

The Moorings 4400

EXTRA CHARTER YACHT EQUIPMENT LIST

ELECTRICAL INSTALLATION

Raymarine Instrument Package: includes Ray55 VHF at navstation, p70 color autopilot, C95 chartplotter with WiFi, i60 wind instrument & i50 Tridata speed, log & depth instrument with retract. depth & speed transducers.
110v or 220v hard wired shore cable. Includes 1 x heavy duty 30amp shore power line, AC switch panel, AC double outlets in cabin, galley and switch panel
Fusion CD player, 2 x *Poly-planer* speakers in saloon & 2 x *Fusion* marine speakers in cockpit
Battery charger 60 amp
AGM upgrade to House and Engine start from Lead Acid
1 x additional AGM House battery (210Ah)
3 x Ventilation fans in saloon & 1 x in each stateroom
Northern Lights 6 kw Genset
2 x *Cruisair* Air Conditioning - Total 32,000 BTU
2 x Solar panels 70w each fitted to hard top
2 x external speakers in forward cockpit

DECK FITTINGS

Removable helmseat spray dodger/windscreen
Custom Davit System with electric winch (stainless steel)
Coachroof side windows removable shade covers

MAST, RIGGING & SAILS

Boom cover stackpack system

PLUMBING INSTALLATION

4 x Electric Flushing toilets in lieu of standard
Stem shower: Hot and cold in lieu of standard
Extra 58USgal / 220L water tank

ENGINE & CONTROLS

2 x *Yanmar* 4JH45 45HP engines in lieu of 29HP

INTERIOR

Berths in port & starboard bow to accommodate children complete with foam cushions and access from forward cabins
Saloon table converts to a double berth with cushions

GENERAL SPECIFICATIONS

Length Overall: 12.98m / 42ft 7in
Waterline Length: 12.70m / 41ft 8in
Mast Height: 20.68m / 67ft 10in
Beam: 7.25m / 23ft 9in
Draft: 1.27m / 4ft 2in
Displacement: 12,615kg / 27,880lb
Fuel Capacity: 700L / 185USgal
Water Capacity: 1,000L / 264USgal
Sail Area: 123sqm / 1,323sqft
Engines: 2 x 45HP

COMMISSIONING

Transport Documentation and Commissioning Package
Transport to CT Harbor, launching and stepping of mast, installation of sails and rigging, commissioning of equipment and sea trials
Antifouling Paint
CE Certification

DELIVERY

Delivery from Cape Town to charter port

SAFETY GEAR

55lb (25kg) Delta Anchor with 230ft (70m) of chain
35lb (15kg) Britney Anchor with 26ft (8m) of chain and 200ft (61m) warp
Anchor Bridle, shackles and hook
6 x Fenders
4 x Mooring lines 18mm (70") x 10m (32'10")
2 x Spring Lines 18mm (70") x 15m (49'2")
10 x Life jackets
Safety Harnesses
Bell
Flare Kit
Binoculars
Navigation tools: Parallel Rule, compass, dividers

CRUISING GEAR

Plates, cups, saucers, glasses for ten (10)
Bed linens for ten (10)
Flatware for ten (10)
Pots, pans, miscellaneous food prep
Cooking & serving utensils
Coffee pot, tea kettle, toaster
Snorkeling gear for ten (10)
Towels and washcloths for ten (10)

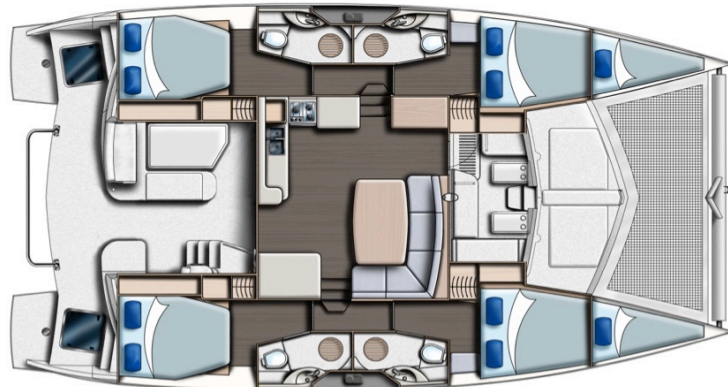

The Builder reserves the right to change or amend the contents of this document at any time without prior notification to any third party and no liability will be accepted for errors contained within the same.